



## **TfL proposal for CP5 Access for All funding: HITHER GREEN**

### ***Station characteristics***

Hither Green is a busy station in the London Borough of Lewisham in south east London. It has an annual footfall of 2.8m passengers, making it one of the 160 busiest stations in Great Britain (ORR 2011/12 data). It is also an interchange between Southeastern services on the main line towards Sevenoaks and the Sidcup route towards Dartford, with ORR data indicating 0.4m passengers per year interchange at this location. There are two bus stops in the vicinity of the station, both of which are fully accessible.

### ***Catchment area***

TfL analysis using 2011 Census data shows that there are 7200 people living within the 960m catchment area of Hither Green station who are under the age of 4, over the age of 65, or have a disability which limits their day-to-day activities either 'a little' or 'a lot'. The station also serves two primary schools and Manor Park Residential Care (care home and assisted living accommodation).

### ***Proximity to other step-free stations***

The nearest step-free station is Lee approximately 1.1 km away, but whilst this station is on the Sidcup route, it does not serve the main line.

### ***Policy and TOC support***

The Station Facility Owner (SFO), Southeastern, is supportive of this scheme being included in the Access for All programme in CP5.

### ***Proposed scheme***

TfL procured consultants to design and cost a scheme to provide step-free access at Hither Green station. Despite the complex layout of the station a feasible scheme has been developed which requires the construction of a high level walkway extending from the existing footbridge across to platforms 5 and 6. Three lifts are required:

- From a footpath at ground level connecting to the subway entrance near Fernbrook Road, rising up to a location behind platform 6 and further up to the end of the new walkway
- Between platform 5 and the new walkway (this will also serve platform 4)
- Between the existing footbridge and platforms 2 / 3

Platform 1 has no regular stopping services and a lift is therefore not proposed at this location. A concept drawing and a visualisation of the new high level walkway extending from the existing footbridge and lifts on platforms 5 and 6, is shown overleaf. The proposal has been costed using actual rates that have been quoted for delivery of the schemes funded by the mid-tier Access for All programme. The cost of making Hither Green step free is estimated at £6.6m including 25% contingency. Full details of the scheme are available on request.

### ***Business case***

An assessment of the value for money of this scheme has been carried out using a methodology based on that developed by Steer Davies Gleave for the DfT. The benefit-

cost ratio of the scheme is calculated as 0.8 to 1 on this basis, based on conventional transport benefits.

**Concept drawing**

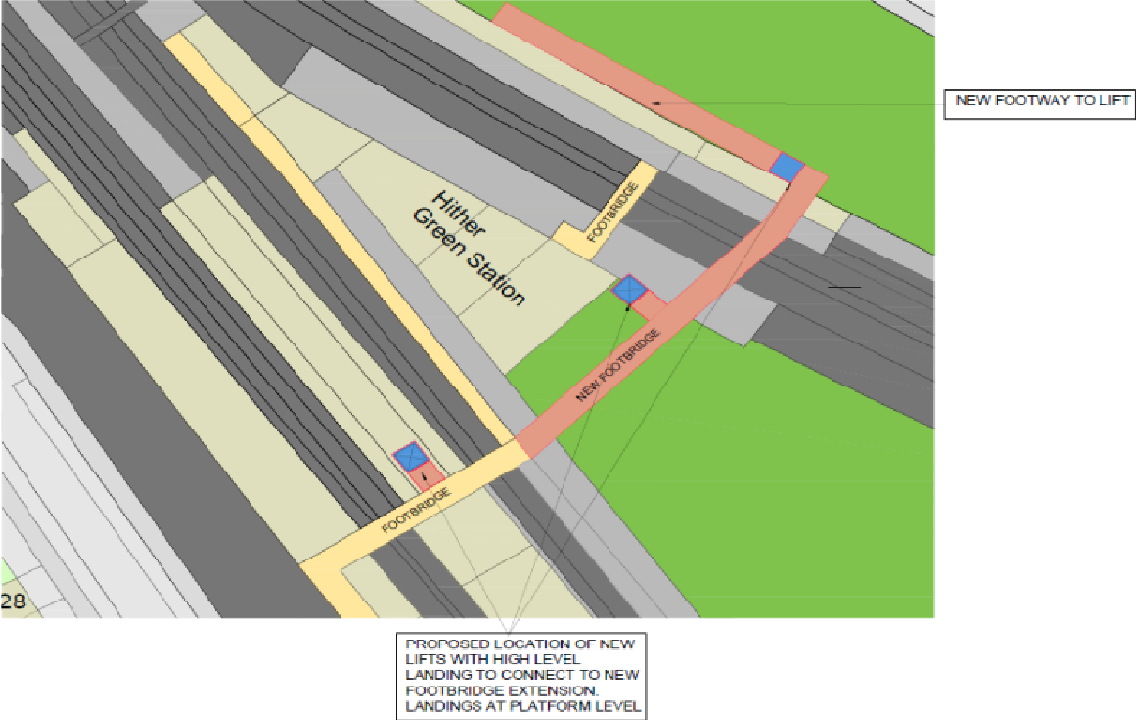

**Visualisation**

